

Section 1 - Overview

The IntelliFlex I/O 3-Command Single Zone or Dual Zone wall switch is a smart user input device that can control a single shade or group of shades.

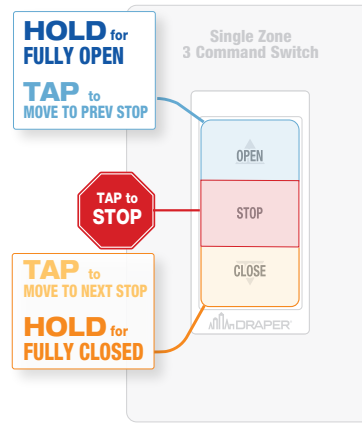

SCAN QR FOR INSTRUCTIONS



Section 2 - Mounting

Using supplied fasteners, install switch into standard gang box. Screwless face plate (provided) can be used, or any decora style faceplate can be used if preferred.

Section 3 - Wiring Details

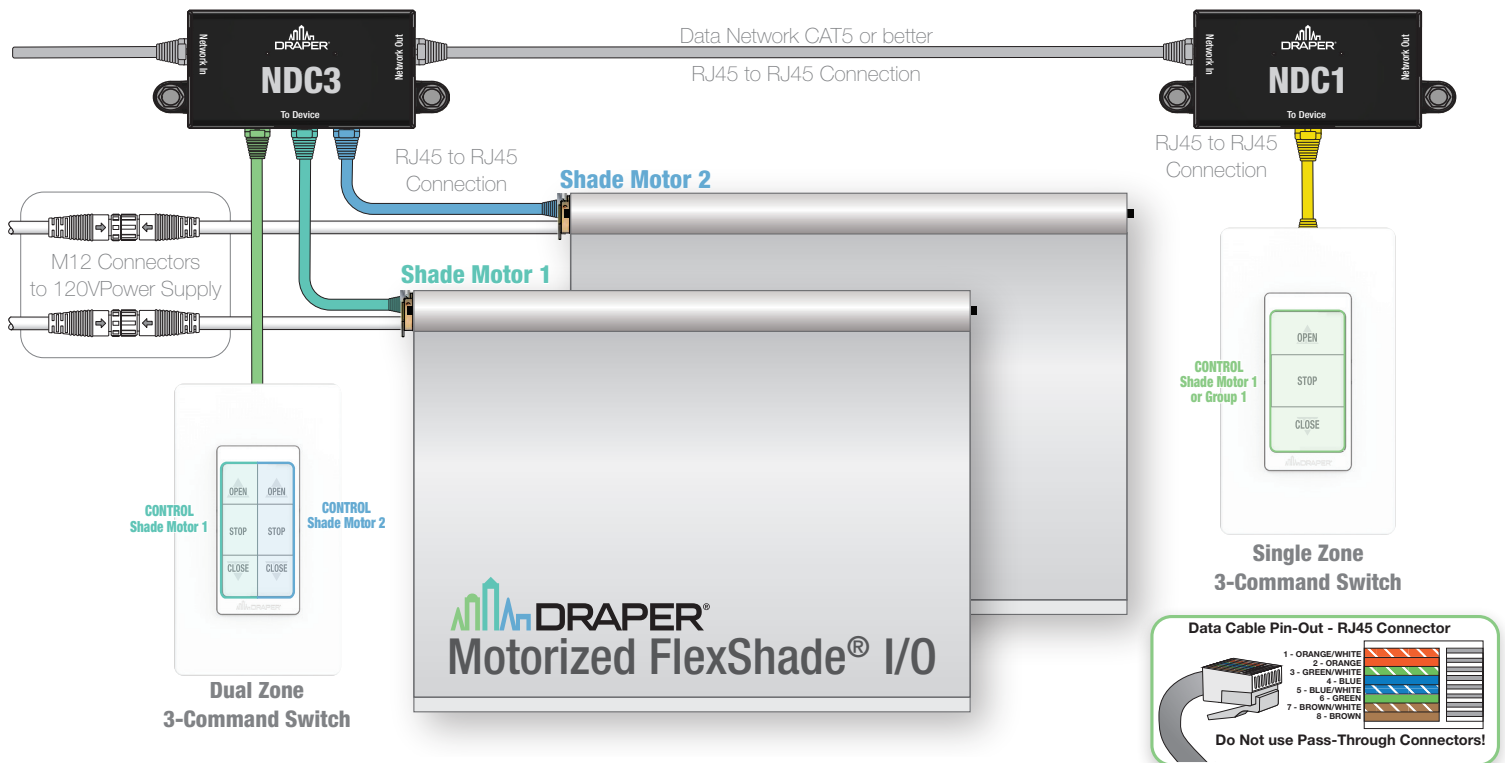

SCAN QR FOR
INSTRUCTIONS



Section 4 - Programming

Please Note: Ensure all low voltage connections have been tested & verified. Attempting to program with faulty wiring can lead to intermittent operation. Refer to MLT (C202.060) Instructions on suggested network verification steps and how to connect MLT into network for programming.

Please Note: It is important to ensure all shade commissioning (limit setting, naming, calibration, etc.) has been completed prior to attempting to program the switch.

4.1 Identify/Select Switch

1. From MLT main menu, select DEVICE SETTINGS then select SWITCH
2. Choose Switch from list of switches on network
3. To identify switch, highlight switch and LEDs on switch will blink rapidly to identify it.

```
Switch 12345-2
>Rename
Zone 1 Master
Zone 2 Grp 12
Factory Reset
```

MLT
SCREEN

4.2 Renaming Switch

1. Select RENAME.
2. Switch can be assigned a numerical value for easier identification.

```
Switch 12345-2
Number
>12345
Extension
2
```

4.3 Configuring Switch Parameters

1. Select Switch Zone to configure
2. If using a Dual Zone switch, Zone 1 is the left zone & Zone 2 is the right zone.

From this menu, you can configure the following parameters:

- Group:** Assigning switch to previously configured shade group or assign as a MASTER.
- Priority:**
 - Low - switch will only operate if there are no other overrides on the group
 - Normal - switch will operate shade group if no HIGH priority overrides on the group
 - High - Switch will lock-out all other controls until cleared
- Override Time:** Time in minutes that the switch override will be active. The range can be NONE (indefinite override) or anywhere from 1-999 minutes

```
Switch 1234567
Zone 1
>Group Grp 4
Priority Normal
Profile
3 Button
Override Time
None
```

Section 4.4 Factory Reset

1. Select Factory Reset from the menu to return switch to default factory settings (master control).

Section 5 - Switch Operation

To operate the switch:

Action	Command Response
HOLD OPEN	Move Fully Open
Tap OPEN	Move to Previous Stop
Tap STOP	Stop Shade Motion
Tap CLOSE	Move to Next Stop
HOLD CLOSE	Move Fully Closed

