

Salara/Series M

Spring Roller
Operated
Projection Screen

DRAPER

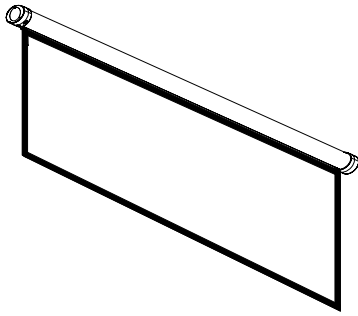

Specifications—Salara/Series M

_____ projection screens, size _____ h. x _____ w. Elliptical case of extruded aluminum, with painted white finish. Injection molded plastic endcaps with domed contour shape, finished to match case. Case shall accept adjustable mounting brackets that snap easily into place and slide anywhere along length of case. Viewing surface to be flame and mildew resistant. Fabric attached to 1³/₄" (4.4 cm) diameter roller to prevent screen from retracting uncontrolled in the case. Bottom of viewing surface attached to 7/8" (2.2 cm) diameter roll formed steel dowel, finished white. Matt White XT1000E and Contrast Grey XH800E viewing surfaces are certified to GREENGUARD standards for low chemical emissions into indoor air during product usage. For more information, visit ul.com/gg.

Specifications subject to change without notice.

Please Check All Appropriate Selections

Select Viewing Surface:

- Matt White XT1000E (1.0 gain): GREENGUARD Gold certified
- Glass Beaded CH3200E (3.2 gain): Optional
- Argent White XH1500E (1.5 gain): Optional
- Contrast Grey XH800E (0.8 gain) (Optional): GREENGUARD Gold certified
- Other: _____

Select Border/Drop Options:

- Black Masking Borders (Standard on NTSC, HDTV & WideScreen sizes)
- Extra Screen Drop (Total screen height cannot exceed 9")
 - Same color as viewing surface (standard on AV format screens)
 - Black (standard on all other formats)

Length of total drop (including standard 12" on some sizes—see grid at right) ¹ _____

Dimensions & Data

Nominal Diagonal	Image Area (H x W)	Overall Size (H x W)	Case Length	Net Wt. (lbs.)	Qty.
AV Format					
50"	50" x 50"		57 ¹ / ₈ "		18
60"	60" x 60"		67 ¹ / ₈ "		21
70"	70" x 70"		77 ¹ / ₈ "		25
84"	84" x 84"		91 ¹ / ₈ "		30
72"	96" x 96"		103 ⁵ / ₈ "		33
96"	96" x 96"		103 ⁵ / ₈ "		36

NTSC/PAL Video Format (4:3)

6'	42 ¹ / ₂ " x 56 ¹ / ₂ "	46 ¹ / ₂ " x 59 ¹ / ₂ "	67 ¹ / ₈ "		20
7'	50" x 66 ¹ / ₂ "	53 ¹ / ₂ " x 69 ¹ / ₂ "	77 ¹ / ₈ "		24
100"	60" x 80"	64" x 83 ¹ / ₂ "	91 ¹ / ₈ "		29
10'	69" x 92"	73" x 96"	103 ⁵ / ₈ "		33

HDTV Format (16:9)

65" ¹	31 ³ / ₄ " x 56 ¹ / ₂ "	43 ³ / ₄ " x 59 ¹ / ₂ "	67 ¹ / ₈ "		19
73" ¹	36" x 64"	48" x 69 ¹ / ₂ "	77 ¹ / ₈ "		23
82" ¹	40 ¹ / ₂ " x 72"	52 ¹ / ₂ " x 74"	81 ⁵ / ₈ "		25
92" ¹	45" x 80"	57" x 83 ¹ / ₂ "	91 ¹ / ₈ "		27
100" ¹	49" x 87"	61" x 91"	98 ⁵ / ₈ "		32
106" ¹	52" x 92"	64" x 96"	103 ⁵ / ₈ "		35

16:10 Format

67" ¹	35 ¹ / ₄ " x 56 ¹ / ₂ "	47 ¹ / ₄ " x 59 ¹ / ₂ "	67 ¹ / ₈ "		19
76" ¹	40" x 64"	52" x 69 ¹ / ₂ "	77 ¹ / ₈ "		23
85" ¹	45" x 72"	57" x 74"	81 ⁵ / ₈ "		25
94" ¹	50" x 80"	62" x 83 ¹ / ₂ "	91 ¹ / ₈ "		27
109" ¹	57 ¹ / ₂ " x 92"	69 ¹ / ₂ " x 96"	103 ⁵ / ₈ "		32

Custom Size

¹ These sizes include 12" black drop as standard.

Also available in 1.85:1, 2.35:1 and 15:9 Formats. Contact Draper.

Salara—Method of Installation

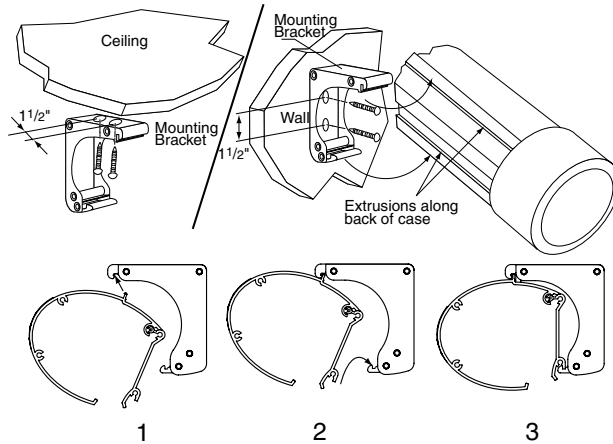

Salara—Dimensions

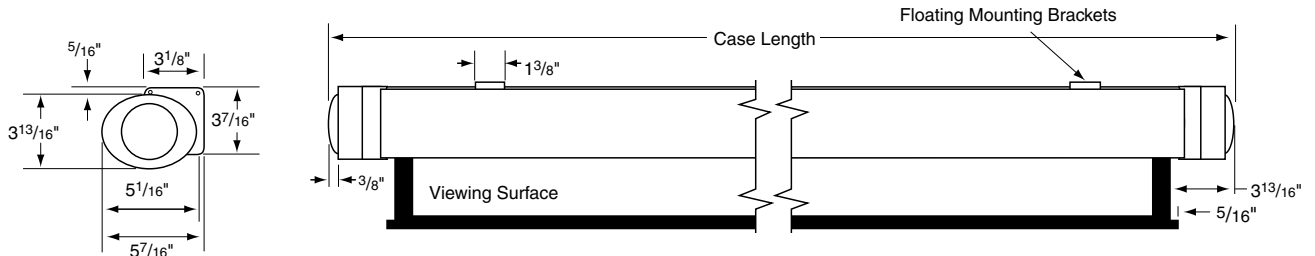

DRAPER

411 S. Pearl St., Spiceland, IN 47385 USA ■ 765-987-7999
www.draperinc.com ■ fax 765-987-7142

Copyright © 2014 Draper Inc. Form SalaraM_Sub14-R

Printed in U.S.A.

PROJECT:	_____
ARCHITECT:	_____
CONTRACTOR:	_____
SUPPLIER:	_____
DATE:	_____
REVISED:	_____