

# Salara/Series M

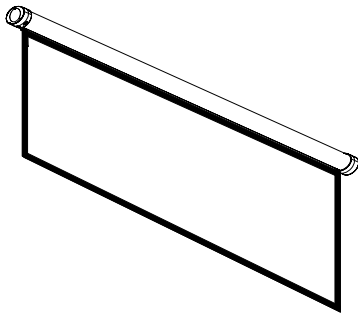

Spring Roller  
Operated  
Projection Screen

# DRAPER



## Specifications—Salara/Series M with AutoReturn

\_\_\_\_\_ projection screens, size \_\_\_\_\_ h. x \_\_\_\_\_ w. Elliptical case of extruded aluminum, with painted white finish. Injection molded plastic endcaps with domed contour shape, finished to match case. Case shall accept adjustable mounting brackets that snap easily into place and slide anywhere along length of case. Viewing surface to be flame and mildew resistant. Fabric attached to 1<sup>3</sup>/<sub>4</sub>" (4.4 cm) diameter AutoReturn roller to prevent screen from retracting uncontrolled in the case. Bottom of viewing surface attached to 7<sup>7</sup>/<sub>8</sub>" (2.2 cm) diameter roll formed steel dowel, finished white. Matt White XT1000E and Contrast Grey XH800E viewing surfaces are certified to GREENGUARD standards for low chemical emissions into indoor air during product usage. For more information, visit [ul.com/gg](http://ul.com/gg). U.S. Patent Pending. Specifications subject to change without notice.

### Please Check All Appropriate Selections

#### Select Viewing Surface:

- Matt White XT1000E (1.0 gain): GREENGUARD Gold certified
- Glass Beaded CH3200E (3.2 gain): Optional
- Argent White XH1500E (1.5 gain): Optional
- Contrast Grey XH800E (0.8 gain) (Optional): GREENGUARD Gold certified
- Other: \_\_\_\_\_

#### Select Border/Drop Options:

- Black Masking Borders (Standard on NTSC, HDTV & WideScreen sizes)
- Extra Screen Drop (Total screen height cannot exceed 9")
  - Same color as viewing surface (standard on AV format screens)
  - Black (standard on all other formats)

Length of total drop (including standard 12" on some sizes—see grid at right) <sup>1</sup> \_\_\_\_\_

### Dimensions & Data

Nominal Diagonal	Image Area (H x W)	Overall Size (H x W)	Case Length	Net Wt. (lbs.)	Qty.
<b>AV Format</b>					
	50" x 50"		57 <sup>1</sup> / <sub>8</sub> "		18
	60" x 60"		67 <sup>1</sup> / <sub>8</sub> "		21
	70" x 70"		77 <sup>1</sup> / <sub>8</sub> "		25
	84" x 84"		91 <sup>1</sup> / <sub>8</sub> "		30
	72" x 96"		103 <sup>5</sup> / <sub>8</sub> "		33
	96" x 96"		103 <sup>5</sup> / <sub>8</sub> "		36
<b>NTSC/PAL Video Format (4:3)</b>					
6'	42 <sup>1</sup> / <sub>2</sub> " x 56 <sup>1</sup> / <sub>2</sub> "	46 <sup>1</sup> / <sub>2</sub> " x 59 <sup>1</sup> / <sub>2</sub> "	67 <sup>1</sup> / <sub>8</sub> "		20
7'	50" x 66 <sup>1</sup> / <sub>2</sub> "	53 <sup>1</sup> / <sub>2</sub> " x 69 <sup>1</sup> / <sub>2</sub> "	77 <sup>1</sup> / <sub>8</sub> "		24
100"	60" x 80"	64" x 83 <sup>1</sup> / <sub>2</sub> "	91 <sup>1</sup> / <sub>8</sub> "		29
10'	69" x 92"	73" x 96"	103 <sup>5</sup> / <sub>8</sub> "		33
<b>HDTV Format (16:9)</b>					
65" <sup>1</sup>	31 <sup>3</sup> / <sub>4</sub> " x 56 <sup>1</sup> / <sub>2</sub> "	43 <sup>3</sup> / <sub>4</sub> " x 59 <sup>1</sup> / <sub>2</sub> "	67 <sup>1</sup> / <sub>8</sub> "		19
73" <sup>1</sup>	36" x 64"	48" x 69 <sup>1</sup> / <sub>2</sub> "	77 <sup>1</sup> / <sub>8</sub> "		23
82" <sup>1</sup>	40 <sup>1</sup> / <sub>2</sub> " x 72"	52 <sup>1</sup> / <sub>2</sub> " x 74"	81 <sup>5</sup> / <sub>8</sub> "		25
92" <sup>1</sup>	45" x 80"	57" x 83 <sup>1</sup> / <sub>2</sub> "	91 <sup>1</sup> / <sub>8</sub> "		27
100" <sup>1</sup>	49" x 87"	61" x 91"	98 <sup>5</sup> / <sub>8</sub> "		32
106" <sup>1</sup>	52" x 92"	64" x 96"	103 <sup>5</sup> / <sub>8</sub> "		34
<b>16:10 Format</b>					
67" <sup>1</sup>	35 <sup>1</sup> / <sub>4</sub> " x 56 <sup>1</sup> / <sub>2</sub> "	47 <sup>1</sup> / <sub>4</sub> " x 59 <sup>1</sup> / <sub>2</sub> "	67 <sup>1</sup> / <sub>8</sub> "		19
76" <sup>1</sup>	40" x 64"	52" x 69 <sup>1</sup> / <sub>2</sub> "	77 <sup>1</sup> / <sub>8</sub> "		23
85" <sup>1</sup>	45" x 72"	57" x 74"	81 <sup>5</sup> / <sub>8</sub> "		25
94" <sup>1</sup>	50" x 80"	62" x 83 <sup>1</sup> / <sub>2</sub> "	91 <sup>1</sup> / <sub>8</sub> "		27
109" <sup>1</sup>	57 <sup>1</sup> / <sub>2</sub> " x 92"	69 <sup>1</sup> / <sub>2</sub> " x 96"	103 <sup>5</sup> / <sub>8</sub> "		32
<b>Custom Size</b>					

<sup>1</sup> These sizes include 12" black drop as standard.

Also available in 1.85, 2.35:1 and 15:9 Formats. Contact Draper.

### Salara—Method of Installation

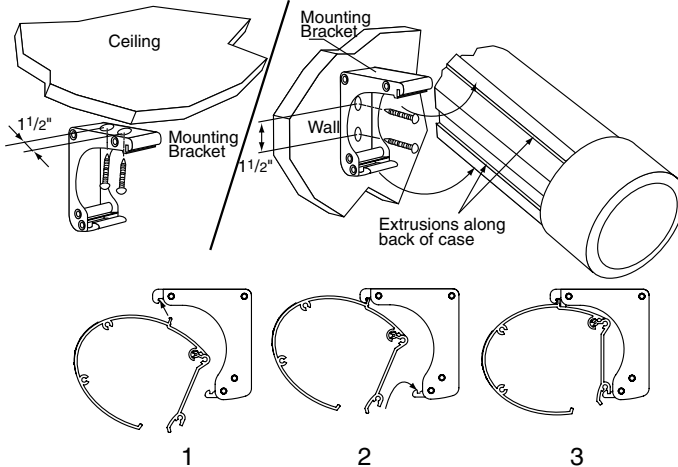

### Salara—Dimensions

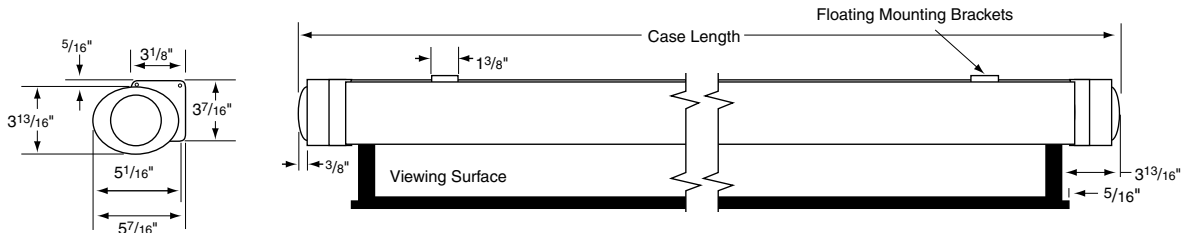

# DRAPER

411 S. Pearl St., Spiceland, IN 47385 USA ■ 765-987-7999  
www.draperinc.com ■ fax 765-987-7142

Copyright © 2014 Draper Inc. Form SalaraM\_AR\_Sub14-R Printed in U.S.A.

PROJECT: \_\_\_\_\_

ARCHITECT: \_\_\_\_\_

CONTRACTOR: \_\_\_\_\_

SUPPLIER: \_\_\_\_\_

DATE: \_\_\_\_\_ REVISED: \_\_\_\_\_