

Installation Instructions FlexShade® Zip with Crank by Draper

⚠ Caution

- ① Inspect all boxes to make sure you have received the proper parts.
- ② Open cartons lengthwise.
- ③ All hardware must be installed level. Shades must be level and square.
- ④ Fasteners are not supplied by Draper. It is the responsibility of installer to make sure that appropriate ones for the mounting surface are used. For Jamb Mounting, Draper recommends the use of low profile head screws to allow the "zipper" to easily pass through the Side Channels.
- ⑤ For installing units in recessed areas where there isn't room to mount the Headbox to the Side Channels, please see note on page two.
- ⑥ FlexShade Zip is designed to operate only when the fabric panel is installed vertically, perpendicular to the ground. Angled installations, where the side channels are NOT installed vertically, may prevent the unit from closing.
- ⑦ DO NOT run down shade cloth outside of the Side Channels.
- ⑧ **Please read the following installation guidelines thoroughly and follow them carefully. Failure to do so may cause product to fall or otherwise fail, and invalidates warranty.**

Preparation for Installation

- ① Make sure mounting surface is strong enough to hold the FlexShade Zip.
Please Note: It is the responsibility of installer to use appropriate fasteners for the mounting surface.

- ② Verify unit measurements, and make sure it will fit in the desired location.
Please Note: The Hembar **does not** retract into the Headbox. This will need to be accounted for if mounting over a swinging window or door.

- ③ Mounting brackets MUST be installed with a gap of 1 3/4" (45mm) between the End Cap and the Mounting Bracket edge (See Fig. 1). Mark wall, jamb or ceiling.

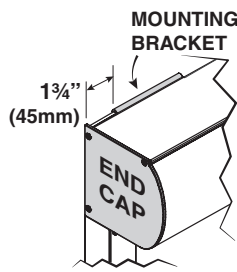
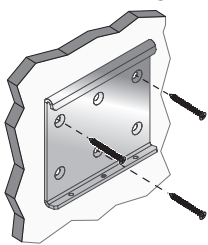

Figure (1)

- ④ Drill small starter holes (if necessary) in mounting surface.

*** If Installing Zip 127 Angled Headbox see page 3. ***

Mounting Headbox with Brackets - Wall Installation



Attaching Mounting Brackets

- ① Attach mounting brackets to the wall using #10 flat head screws installed flush with bracket. Be sure to use AT LEAST 2 of the top mounting holes (See Fig. 2).

Figure (2)

- ② Attach Headbox to brackets and tighten Set Screws (See Fig. 3).

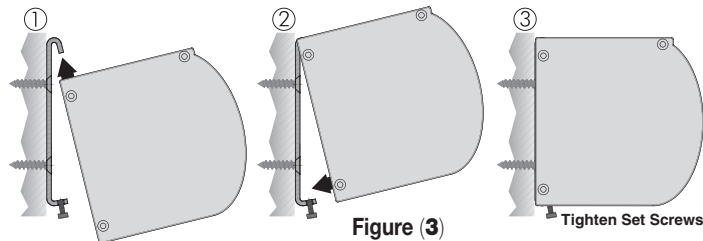

Figure (3)

- ③ You are now ready to mount the Side Channels (See Page 2).

DRAPER

411 S. Pearl St., Spiceland, IN 47385 USA ■ 765-987-7999

www.draperinc.com ■ fax 765-987-7142

Copyright © 2017 Draper Inc. Form FlexShadeZip_Crank_Inst17 Printed in U.S.A.

Mounting Headbox - Permanently to Ceiling or Wall

① Attaching Mounting Brackets to Headbox

Attach **Mounting Brackets** to the Headbox as a spacer between the Headbox and the wall.

Leave a 1 3/4" (45mm) gap between **End Cap** and **Mounting Bracket** (See Fig. 4), and tighten set screws.

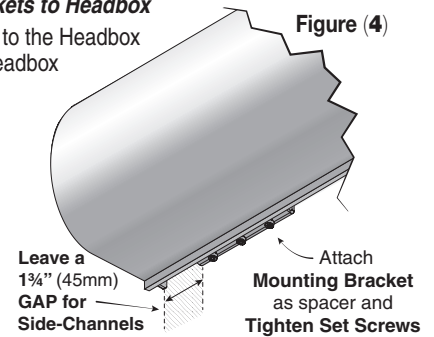

Figure (4)

② Removing Roller Assembly

A. Remove screws from bottom of Headbox, remove Fascia.

B. Remove 2 screws from Crank, and remove Crank from Operator End.

C. Remove Quick Release Pin from Idler End of Roller Assembly.

D. Remove Roller Assembly, Idler End first, and set aside.

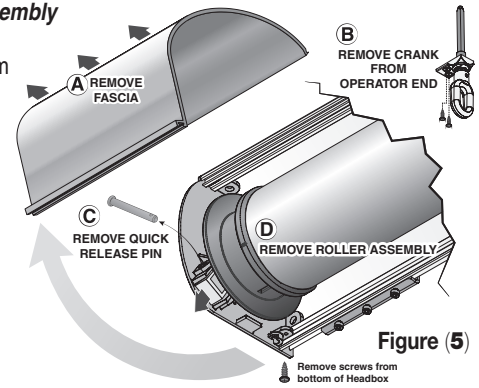

Figure (5)

③ Mounting to Ceiling / Wall

Using the mounting holes in the end caps as a guide (See Fig. 6), drill pilot holes on both ends of the Headbox. Attach to mounting surface using appropriate fasteners.

Please Note: It is the responsibility of installer to use appropriate fasteners for the mounting surface.

- ④ Once the Headbox is secured to the mounting surface, re-install **Roller Assembly***, **Quick Release Pin** and **Fascia**.

*Note: If there is no cable exit provided, you must drill one before re-installing Roller Assembly. See **Cable Exit** on Page 4.

- ⑤ You are now ready to mount the Side Channels (See Page 2).

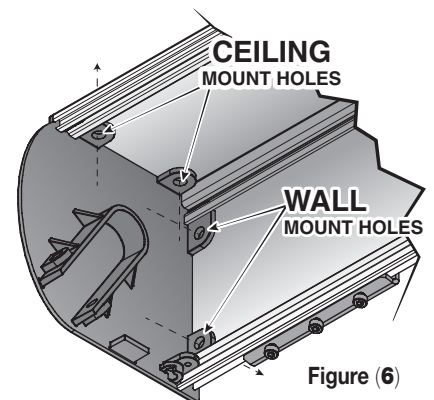

Figure (6)

Continued on next page

If you encounter any difficulties installing or servicing your FlexShade Zip, call your dealer or Draper, Inc. in Spiceland, Indiana, 765-987-7999, or fax 765-987-7142.

Mounting Side Channels

Preparation

- ① Use 3mm Hex Wrench to remove Screws from Side Channels and set aside.
- ② Remove Side Channel Covers. **Please Note: Do NOT remove the Bottom Caps from Side Channels.**
- ③ For jamb mounting, also remove the Fabric Retainer Strip and set aside.
- ④ Drill through Side Channels at desired mounting points (See Fig. 7).
- ⑤ Mark wall or jamb and drill small pilot holes in mounting surface.

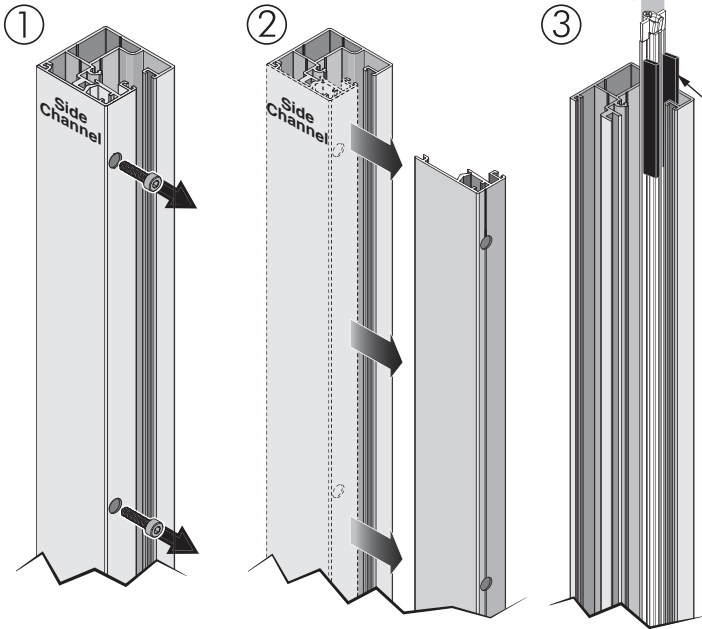

Neoprene cushions on the retainer strip (shown in black) **ARE NOT TO BE REMOVED.** If they come off, replace using double-sided tape.

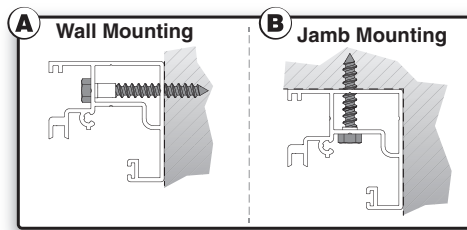
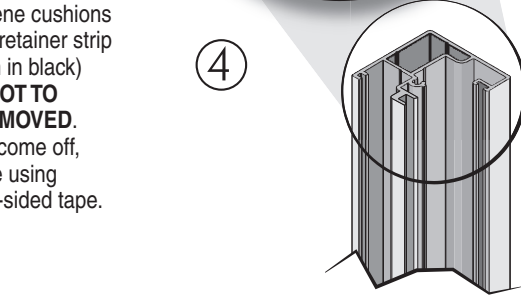
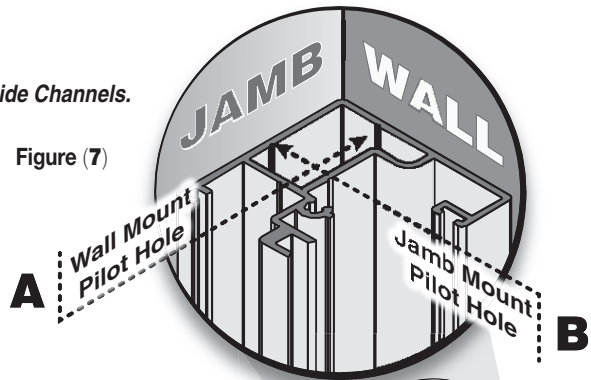

Attaching Side Channels to Mounted Headbox

- ⑥ Insert Side-Channel Guide and Fabric Retainers into Side Channels (See Fig. 8).

Please Note: Make sure Fabric Retainers go back into the Side Channels with Fabric Guide at top of Side Channels and angled leg oriented towards the back (see Fig. 8).

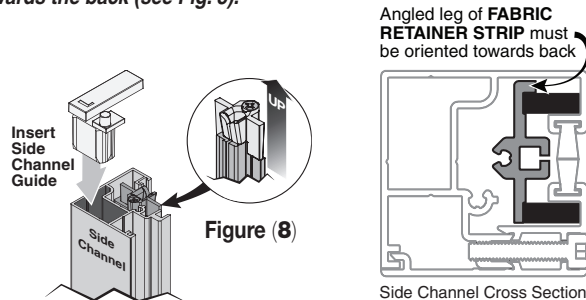

- ⑦ Insert "Zipper" on one side of the Hem Bar into the fabric retainer in the Side Channels (See Fig. 9).
- ⑧ With "Zipper" engaged in Fabric Retainer, insert side channel guide into bottom of the endcap (See Fig. 10).
- ⑨ Attach side channel to the mounting surface using appropriate fasteners. ***** IMPORTANT: Side Channels MUST be installed parallel with a tolerance of +/- 1/8" (3mm).**
- ⑩ Repeat Steps ⑦ - ⑨ for the other Side Channel.
- ⑪ Re-attach Side Channels Covers using the screws removed in Step 1.

Please Note:
Failure to use provided fasteners to re-attach side channel covers may result in product failure in high wind.

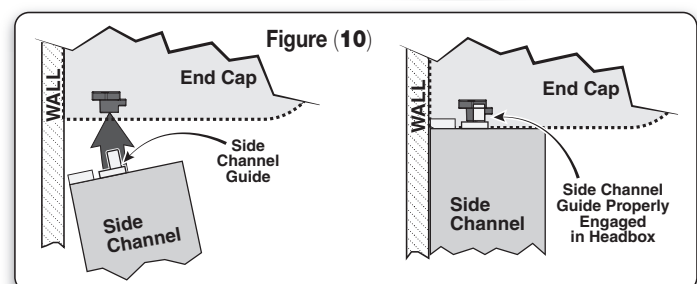
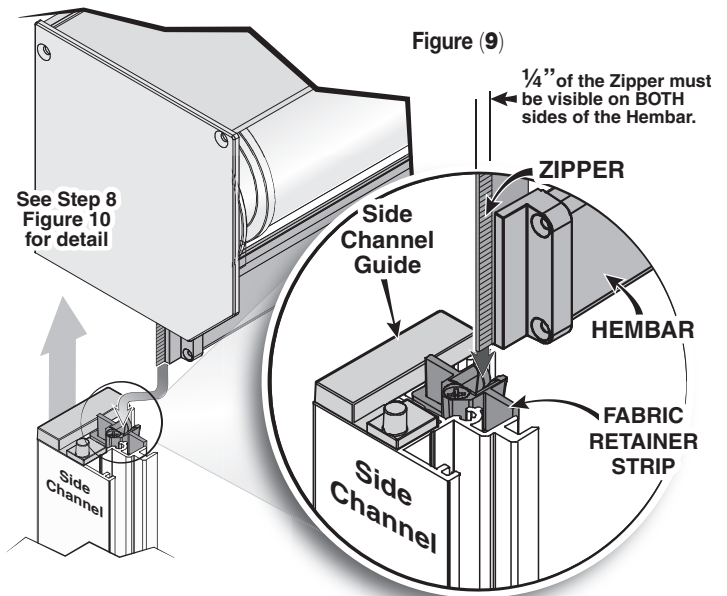

Mounting Headbox - Zip 127 Angled Headbox

The FlexShade Zip 127 Angled Headbox can be mounted permanently to the wall or ceiling (See *Mounting Headbox - Permanently to Ceiling or Wall on page 1*); or the Headbox can rest atop the Side Channels and is held in place there by two mounting studs coming down from the endcaps.

PLEASE NOTE:

Steps ①-⑤ of the Mounting Side Channels section must be completed before mounting the Zip 127 Angled Headbox. **It is critical that the full length of each Side Channel is secured to the mounting surface.**

① Remove screws from bottom of Headbox, remove Fascia and set aside. (See Fig. 11).

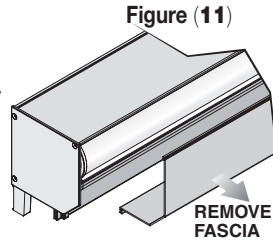

Figure (11)

② Insert "Zipper" on one side of the Hem Bar into the fabric retainer in the Side Channels (See Fig. 12).

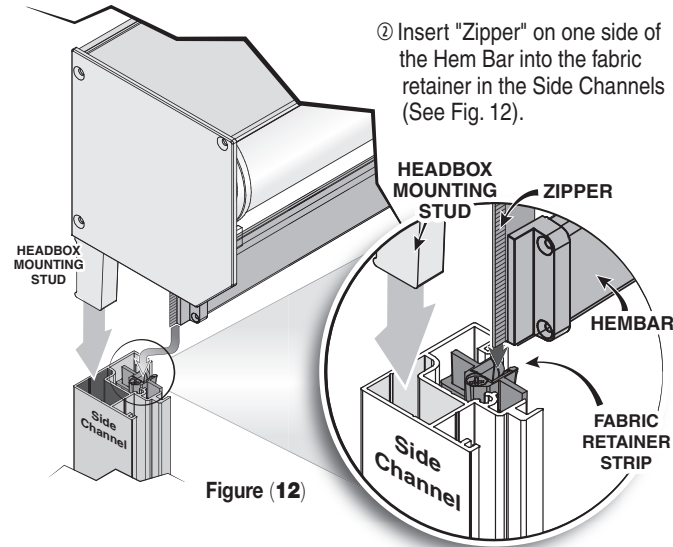

Figure (12)

③ Insert "Zippers" on the side of the Hem Bar into the fabric retainers in the Side Channels (See Fig. 12).

④ Insert Headbox mounting stud into Side Channel (See Fig. 12).

⑤ Return Fabric Retainers to Side Channels and re-attach Covers.

Pocket Installation

The FlexShade Zip can also be installed in a pocket in the ceiling. You must provide adequate clearance for removal of the Roller Assembly during installation and maintenance.

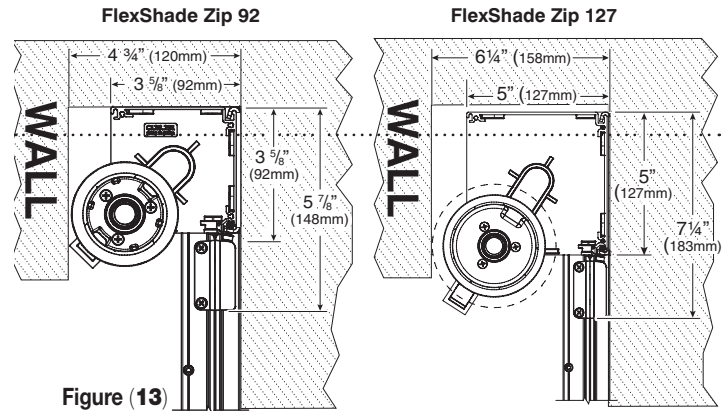

Figure (13)

The minimum depth of the ceiling pocket for the FlexShade Zip 92 is 4 3/4" (120mm), and for the FlexShade Zip 127 is 6 1/4" (158mm). See Fig 13 below.

Alternate Mounting for Jamb Recessed Installations (Zip 127 Angled Only)

If the system is installed in a recess, it is unlikely that there will be sufficient space above the side channels to allow the Headbox to be mounted onto them.

In these instances follow the steps for preparing the system (See *Mounting Headbox - Zip 127 Angled Headbox*). Then mount the Headbox onto the side channels and present the entire system into the opening. Hold the system in position and use appropriate screws to fix the side channels in place. Apart from this, the other steps should be followed as described.

Attaching Anti-Insect Brush Seals (Optional)

The FlexShade Zip has optional Anti-Insect Brush Seals pre-installed along the width of the fascia. There are also brush seals supplied for each of the side channels that will need to be installed. Remove the double-sided tape and apply to the side channels as shown at right (Fig. 15).

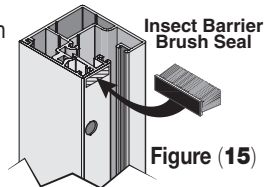

Figure (15)

Cleaning and Maintenance

Window covering products manufactured by Draper, when properly installed, should require no operational maintenance or lubrication.

Most of Draper's standard fabrics can be cleaned at the window by vacuuming with a soft brush attachment. They may also be cleaned by using a sponge or soft cloth and mild solution of warm soapy water. A dishwashing liquid, such as Ivory liquid, is recommended. A clean dry cloth is recommended for the metal finish.

Assembled Dimensions (Front View)

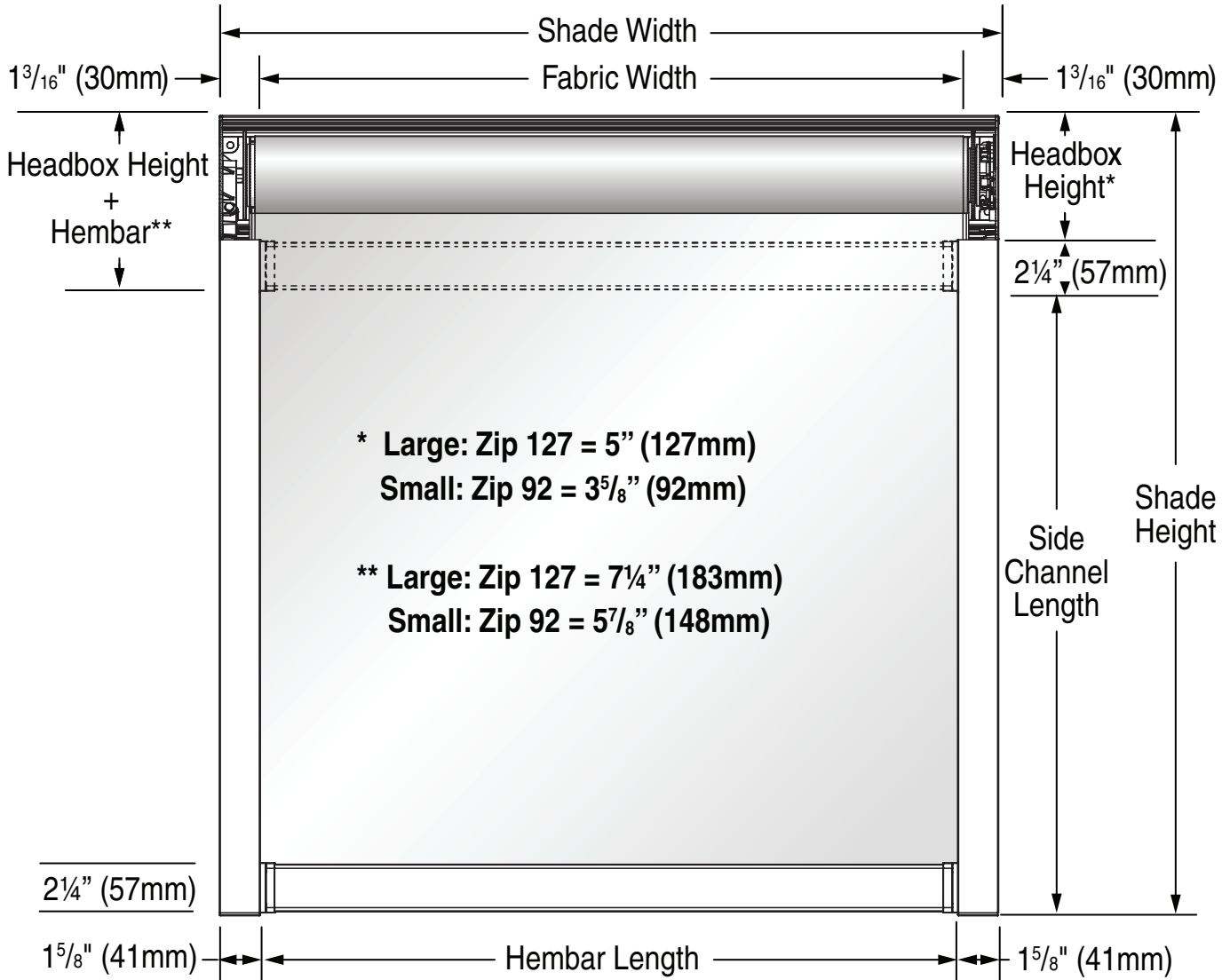

Assembled Dimensions (Side View)

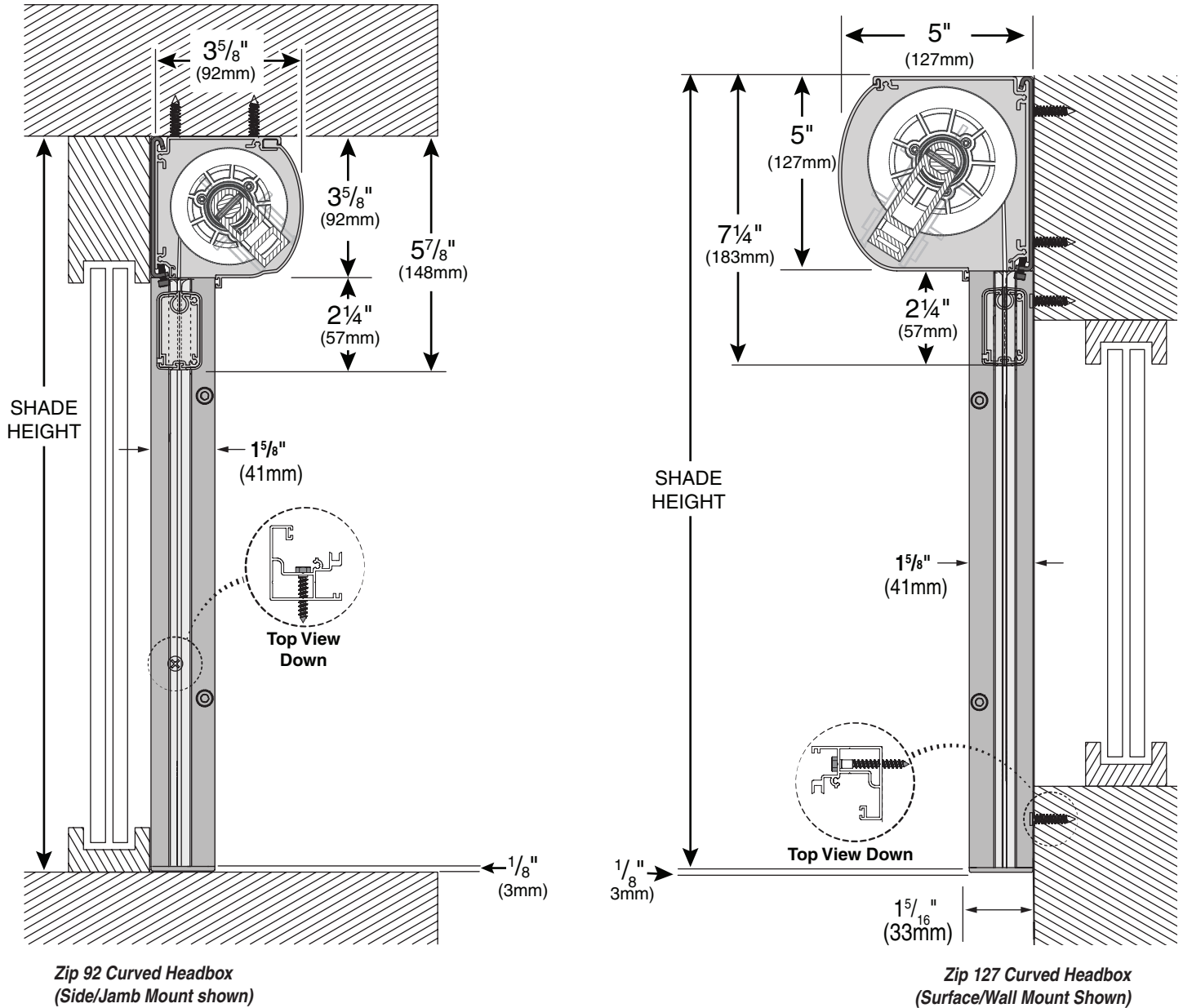

Zip 92 Curved Headbox
(Side/Jamb Mount shown)

Zip 127 Curved Headbox
(Surface/Wall Mount Shown)

Dimensions - Headbox Styles

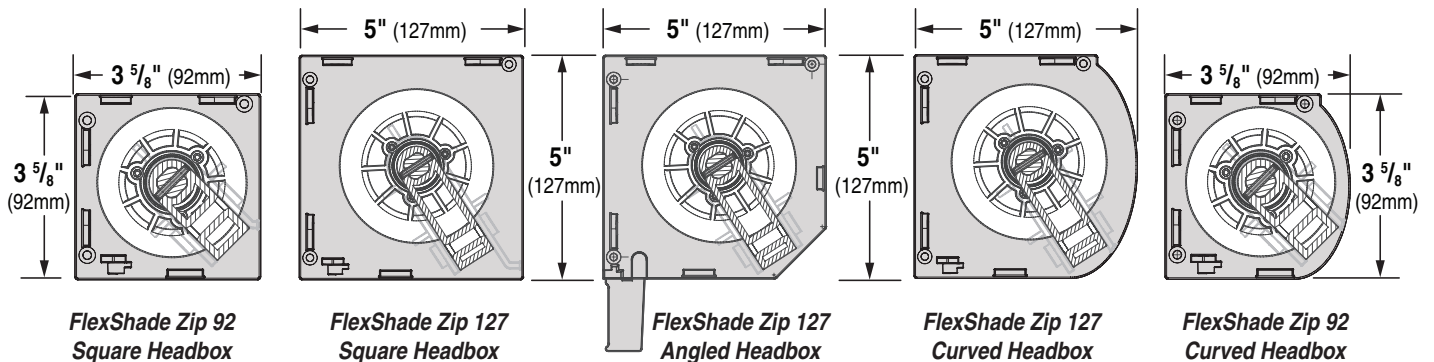

Side Channel Dimensions

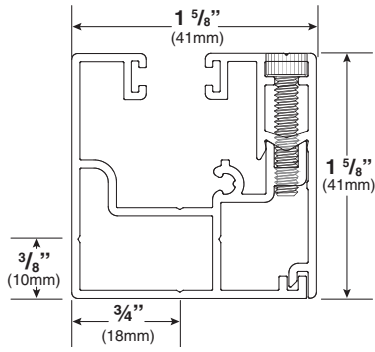

Hembar Dimensions

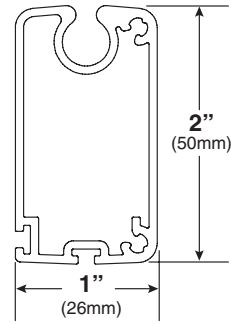

Zip 92 Mounting Bracket

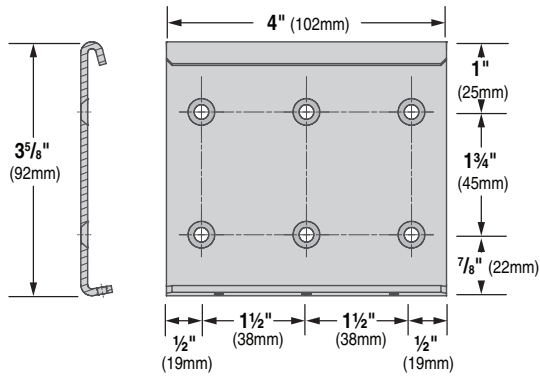

NOTE: Mounting brackets attach to surface with #10 Flat Head Screw

Zip 127 Mounting Bracket

