

Gabled Bottom-Up FlexShade®

Motorized triangular bottom-up shade with tension cables, pulleys, and flexible hem bar

SUBMITTAL
TECHNICAL INFO

FLEXBOTMUP GABL

Please check all appropriate selections and attach room schedule with verified dimensions.

Fabric Series: _____

Color Name / Number: _____

Openness Factor: _____

Please see [Draper® Fabric Options](#) for fabric colors and specifications.

Select Window Type

- Right angle
 - Vertical on Right
 - Vertical on Left
- Trapezoid
 - Taller on Right
 - Taller on Left
- Window Width: _____
(between 37" and 144")
- Window Height
 - Left side: _____
(up to 144")
 - Right side: _____
(up to 144")

Please Note: Remember to check angle: Angle must be between 0 and 45 degrees.

Select Hardware

Select Hardware Type

- Dual: Used when mounting spring boxes at window sill, bundle size may limit its use
- Large: Used when mounting spring boxes at top of window

Select Hardware Options

- With Plastic Endcap Covers (standard)
- Without Plastic Endcaps

Select Hardware Finish

- Black Bronze Ivory
- White Sand Silver

Select Fascia

- Bottom fascia (REQUIRED)
- Top fascia (Optional for Large and Small Hardware)

Please Note:

- The Gabled Bottom Up FlexShade® **cannot** be coupled.
- Reverse rolled fabric, slat styles, and fabric attachment options **not available**.

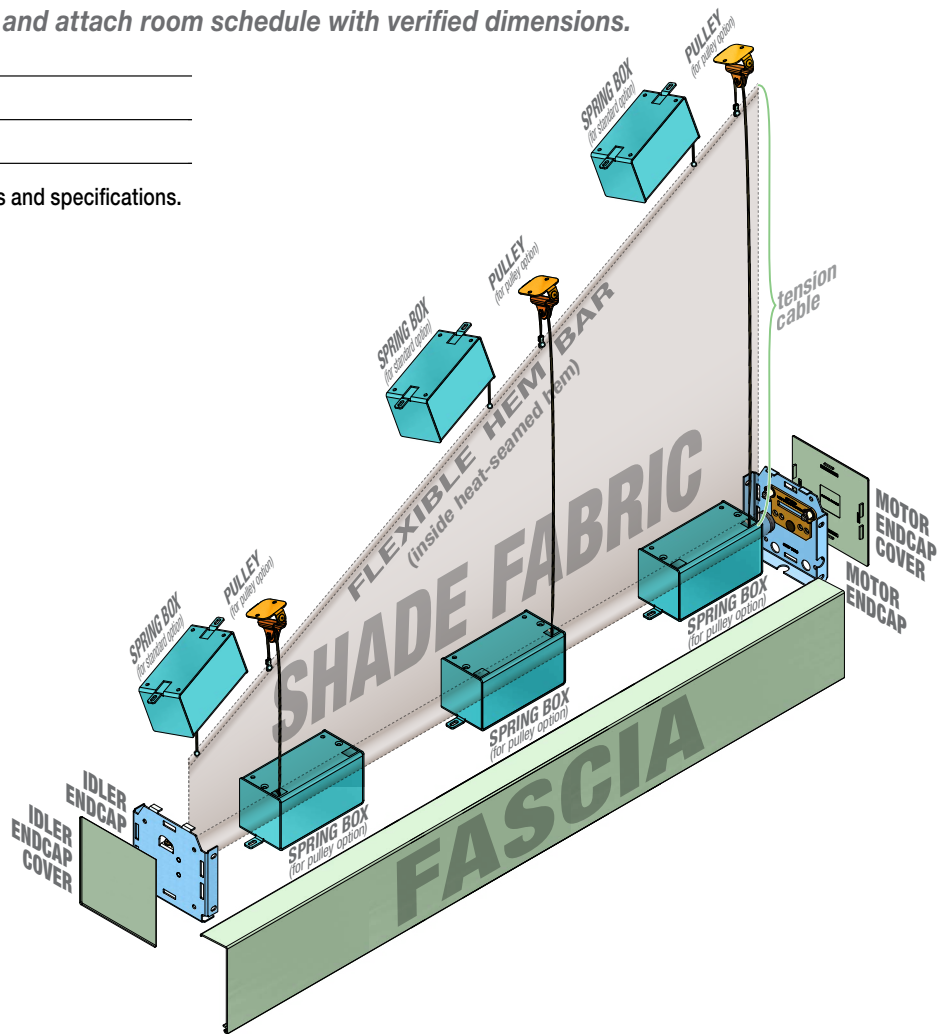

Select Motor Location (front view)

- Right (standard)
- Left

Please Note: Draper® recommends that motor be located on same side of tallest vertical section to minimize light gap.

Select Shade Operating System

- | | |
|--|--|
| <ul style="list-style-type: none"> <input type="checkbox"/> Standard AC Motors <ul style="list-style-type: none"> <input type="checkbox"/> Sonesse® Motor (standard) <input type="checkbox"/> Sonesse® Ultra Motor <input type="checkbox"/> RTS AC Motors <ul style="list-style-type: none"> <input type="checkbox"/> Sonesse® RTS Motor <input type="checkbox"/> Sonesse® Ultra RTS Motor | <ul style="list-style-type: none"> <input type="checkbox"/> 485 AC Motors <ul style="list-style-type: none"> <input type="checkbox"/> Sonesse® RS485 Motor <input type="checkbox"/> Sonesse® Ultra RS485 Motor <input type="checkbox"/> IntelliFlex® I/O 120V I/O Motor <ul style="list-style-type: none"> <input type="checkbox"/> 6 NM AC Motor |
|--|--|

Sonesse® is a registered trademark of Somfy.

Please Note:

For more information about motors and controls, see installation instructions.



Draper, Inc. | 411 S. Pearl St. Spiceland, IN 47385
draperinc.com | 765.987.7999 | 800.238.7999

© 2023 All Rights Reserved | FORM: Gabled_Bottom-Up_FSMO_Sub23-R

PROJECT: _____

ARCHITECT: _____

CONTRACTOR: _____

SUPPLIER: _____

DATE: _____ REVISED: _____

Specifications

HARDWARE

ROLLERS: Extruded aluminum.

ROLLER IDLER ASSEMBLY: Type 6 / 6 injected molded nylon and a zinc-plated cold rolled steel pin. Sliding pin for easy installation and removal of the roller.

ENDCAPS: 1018 steel stamping. 2 sizes: 4 ½" x 4 ½" (114 x 114 mm) and 4 ¾" x 6 ¼" (118 x 173mm). Complete with adapter roller bracket. Installs to wall, ceiling, or jamb. Accepts fascia or headbox.

ENDCAP COVERS: Plastic covers snap onto endcaps. Available in ivory, bronze, black, or white to match fascia.

FABRIC RETAINER: ¼" (6 mm) OD .17" (4 mm) ID linear low-density polyethylene tubing, inside heat seamed hem.

HEM BAR: Flexible 0.005-inch (0.127 mm)-thick steel inside heat-seamed pocket, with studs for attaching tension cables.

LIFTING CABLE: 0.06" (1.5 mm) low-stretch high fatigue cable with polyester jacket.

FASCIA: "L" or radius cover of extruded aluminum, .060 (2 mm) wall. Assembly snaps onto endcaps without exposed fasteners. Clear anodized, black, white, ivory, or bronze powder coat finish available.

STANDARD AC MOTORS

EQUIPMENT

SONESSE® 506 (C047.250): Drive unit inside roller, 4-wire, instantly reversible, lifetime lubricated. Right-hand motor location standard. Left-hand available. Adjustable limit switches, thermal overload protector, and electric brake. Operates on 110-120V AC 1 PH 60 Hz current. Draws 1.2 Amps. Sound levels ≤ 45 dBA.

SONESSE® 510 (C047.251): Drive unit inside roller, 4-wire, instantly reversible, lifetime lubricated. Right-hand motor location standard. Left-hand available. Adjustable limit switches, thermal overload protector, and electric brake. Operates on 110-120V AC 1 PH 60 Hz current. Draws 1.67 Amps. Sound levels ≤ 47 dBA.

SONESSE® ULTRA 506 (C047.244): Drive unit inside roller, 4-wire, instantly reversible, lifetime lubricated. Right-hand motor location standard. Left-hand available. Adjustable limit switches, thermal overload protector and electric brake. Operates on 110-120V AC 1 PH 60 Hz current. Draws 0.95 Amps. Sound levels ≤ 38 dBA.

RTS AC MOTORS

EQUIPMENT

SONESSE® RTS 506 (C047.248): Drive unit inside roller, 3-wire, instantly reversible, lifetime lubricated. Right-hand motor standard. Left-hand available. Built-in radio receiver. Limit switches adjustable by wall switch or remote control. Thermal overload protector and electric brake. Operates on 110-120VAC 1 PH 60 Hz current. Draws 1.2 Amps. Sound levels 44 ≤ dBA.

SONESSE® RTS 510 (C047.249): Drive unit inside roller, 3-wire, instantly reversible, lifetime lubricated. Right-hand motor standard. Left-hand available. Built-in radio receiver. Limit switches adjustable by wall switch or remote control. Thermal overload protector and electric brake. Operates on 110-120VAC 1 PH 60 Hz current. Draws 1.66 Amps. Sound levels 47 ≤ dBA.

SONESSE® ULTRA RTS 506 (C047.245): Drive unit inside roller, 3-wire, instantly reversible, lifetime lubricated. Right-hand motor standard. Left-hand available. Built-in radio receiver. Limit switches adjustable by wall switch or remote control. Thermal overload protector and electric brake. Operates on 110-120V AC 1 PH 60 Hz current. Draws 0.95 Amps. Sound levels ≤ 38 dBA.

485 AC MOTORS

EQUIPMENT

SONESSE® RS485 506 (C047.246): Drive unit inside roller, 3-wire, instantly reversible, lifetime lubricated. Right-hand motor location standard. Left-hand available. Built-in encoder and low-voltage controller with data cable. Limits adjustable using limit setting tool or motor configuration software. Thermal overload protector and electric brake. Operates on 110-120V AC 1 PH 60 Hz current. Draws 1.2 Amps.

SONESSE® RS485 510 (C047.247): Drive unit inside roller, 3-wire, instantly reversible, lifetime lubricated. Right-hand motor location standard. Left-hand available. Built-in encoder and low-voltage controller with data cable. Limits adjustable using limit setting tool or motor configuration software. Thermal overload protector and electric brake. Operates on 110-120V AC 1 PH 60 Hz current. Draws 1.67 Amps.

SONESSE® ULTRA RS485 506 (C047.244): Drive unit inside roller, 4-wire, instantly reversible, lifetime lubricated. Right-hand motor location standard. Left-hand available. Adjustable limit switches, thermal overload protector and electric brake. Operates on 110-120V AC 1 PH 60 Hz current. Draws 0.95 Amps. Sound levels ≤ 38dB.

INTELLIFLEX I/O MOTORS

EQUIPMENT

INTELLIFLEX® I/O 6NM MOTOR (C047.300): Drive unit Inside roller, 3-wire, instantly reversible, lifetime lubricated. Right-hand or left-hand operation selectable during programming. Adjustable electronic limit switches, thermal overload protector, and electric brake. Operates on 110-120V AC 1 PH 60 Hz current. Draws 1.0 Amps. Sound levels ≤ 42 dB.

MOTOR LIMIT TOOL (C202.030): Used to program the limits, operating direction, and preset stops for individual or networks of Draper intelligent motors.

NETWORK DEVICE CONNECTOR (C156.267): Used to connect IntelliFlex I/O devices into a network. Distributes both power and communication between devices.

WIRED WALL SWITCH (SINGLE ZONE C112.161; DUAL ZONE C112.162): Intelligent low-voltage control device providing IntelliFlex I/O-wall user interface. Communicates directly with intelligent motors. Uses priority-based command structure which allows multiple switches to have different levels of authority.

WIRELESS REMOTE (C156.270): Display allows up to 32 channels. Touch control to position shades. Can be used as a simple commissioning tool.

WIRELESS NETWORK GATEWAY (C156.268): Required to use the wireless remote in a wired network.

AV GATEWAY (C156.269): Used to integrate with 3rd party control systems. Supports RS-232 and RS-485. Contact closure inputs. Low-voltage trigger. IR receiver input. LCD display allows for commissioning of serial groups.

MOTOR LIMIT TOOL (C156.273): Used to provide programming of operational direction, upper and lower travel limits, and preset stops for individual or groups of Draper intelligent motors within a network.

CONTACT CLOSURE INTERFACE (C156.273): Used to connect simple switches or other contact closure devices into the network. Up to 6 contacts. Push buttons for commissioning.

CONFIGURATION:

ENDCAPS: Stamped steel with universal design suitable for mounting to ceiling, wall, and jamb. Idler end endcap to have built-in tracking adjustment. Manufacturer to provide size compatible with roller size.

ENDCAP COVERS: To match fascia or headbox color.

FASCIA: L shaped aluminum extrusion to conceal shade roller and hardware.

ATTACHMENT: Snaps onto endcaps without requiring exposed fasteners of any kind. Fascia can be mounted continuously across two or more shade bands. No notching is required.

SHAPE: Square Fascia Panel, Shape: Dual Height Fascia Panel.

FINISH: Selected from Manufacturers standard range; Custom powder coat as selected by the Architect.

HEM BAR: Flexible 0.005-inch (0.127 mm)-thick steel inside heat-seamed pocket, with studs for attaching tension cables.

ROLLER: Fabricated from extruded aluminum. Wall thickness and material selected by manufacturer to accommodate shade size. Provide with roller idler assembly of molded nylon and zinc-plated steel pin. Sliding pin to allow easy installation and removal of roller. Fabric connected to the roller tube with LSE (low surface energy) double sided adhesive specifically developed to attach coated textiles to metal. Adhesive attachment to eliminate horizontal impressions in fabric.

SPRING BOXES: Metal boxes to provide continual tension to keep guide cables under continual tension.

LOCATION: Top of opening; Bottom of opening.

GUIDE CABLES: ¼-inch (1.588 mm) diameter aramid core with a polyester jacket, attached to spring boxes to provide constant tension to shade fabric.

DOWNLOADABLE 3-PART SPECIFICATIONS:

WWW.DRAPERINC.COM

Please note: Dimensions of rollers, operators, and hardware at manufacturer's discretion.

Wiring Diagrams

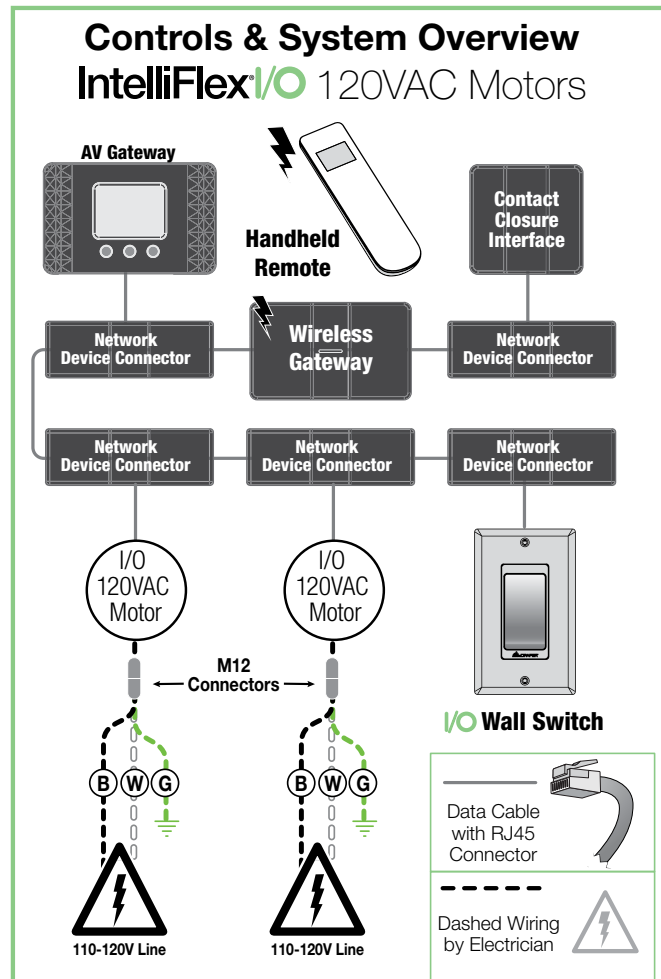
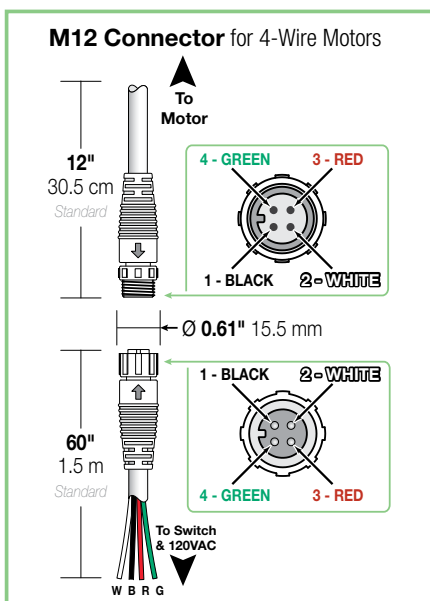
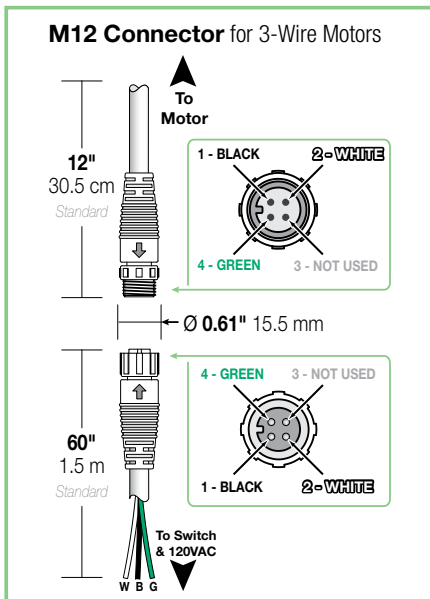
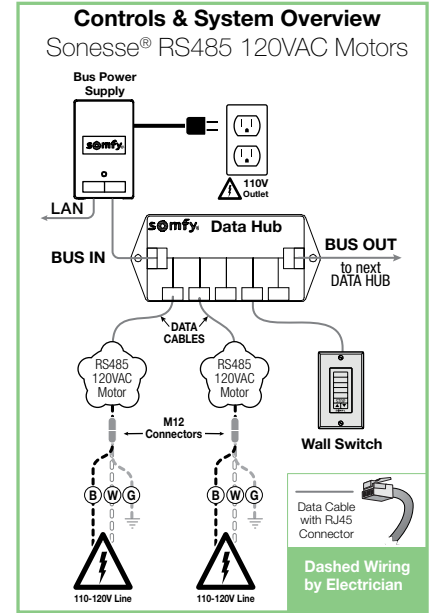
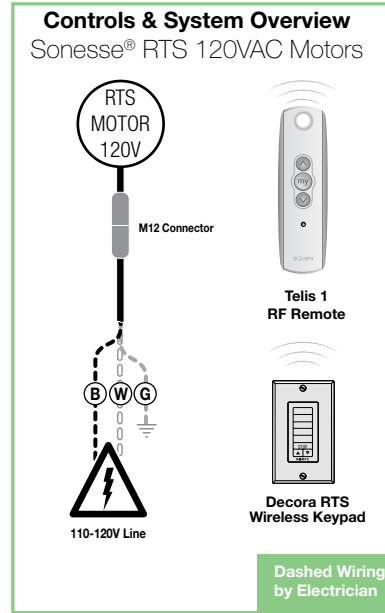
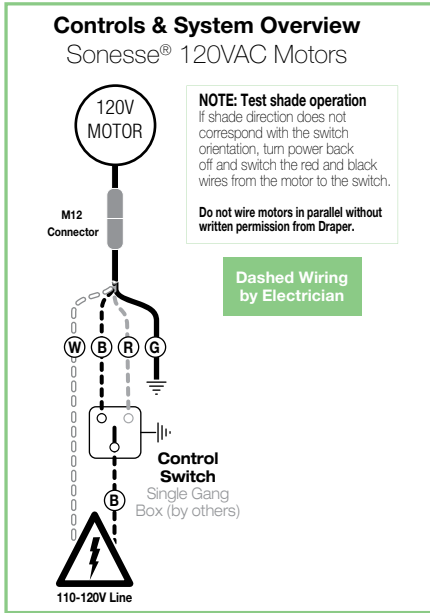

⚠ Caution:
Do not wire motorized units in parallel without written consent from Draper®.

Please Note:
A Draper Motor Test Cable (Part# 503109) and M12 Pigtail (Part# C107.089.60) are recommended for temporary power for testing and limit setting.

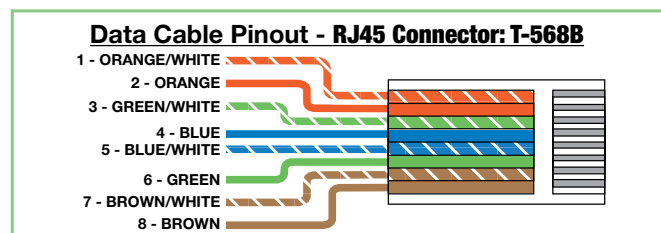

Endcap Dimensions

LARGE HARDWARE

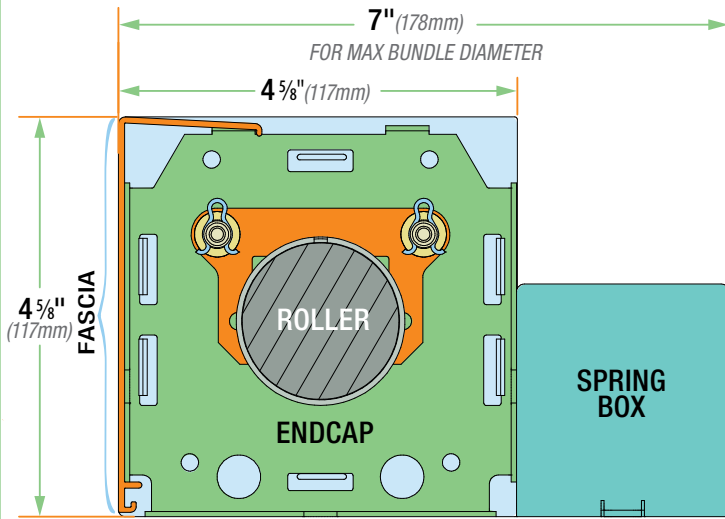

DUAL HEIGHT HARDWARE

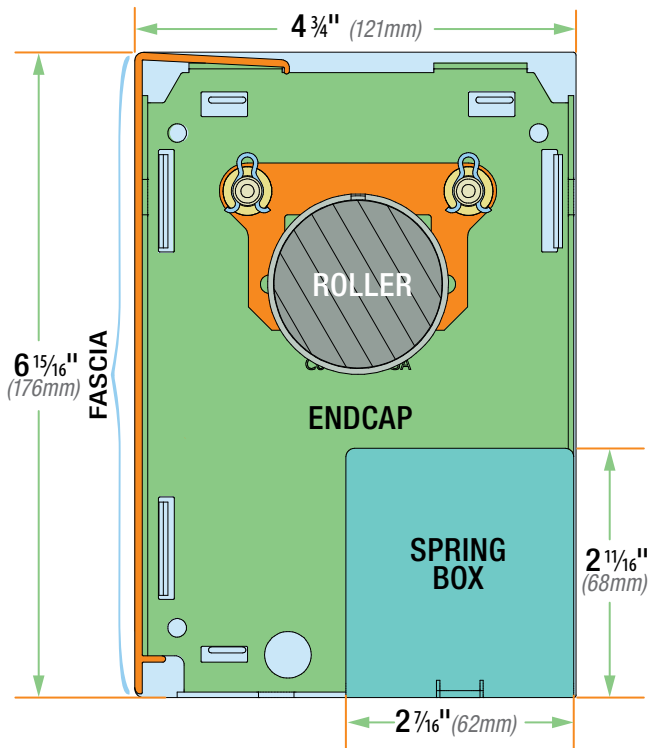

Spring Box Dimensions

