

Installation/Operating Instructions

Environmental Air Space Housing for Scissor Lift SLX by Draper

Environmental Air Space Housing "SLX"

Please Note: Before assembling the housing, you will need to determine which assembly holes you will use, and knock them out.

The Environmental Air Space Housing is shipped in pieces, and must be assembled by the installer. The height of the Environmental Air Space Housing is set by drilling out the knockouts at the desired locations then using screws to connect side panels. It is recommended that an access panel be installed in the ceiling to allow future access. The optional environmental air space housing must be installed to isolate the lift from the "other space used for environmental air."

- ① Insert mounting hardware through the top of the Environmental Air Space Housing **and** the top of the Scissor Lift SLX.
- ② Then, install top panel to Environmental Air Space Housing frame.
- ③ Attach entire assembly to overhead structure using the same mounting hardware from Step 1. Allow clearance between the top of Environmental Air Space Housing and structure for ease of future access.
- ④ Install side and end panels, and trim frame.

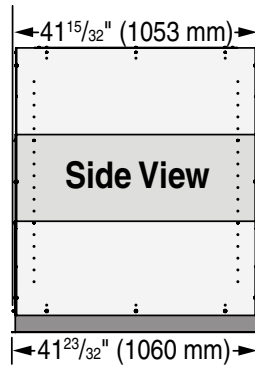
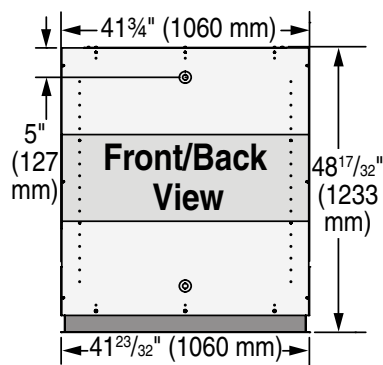
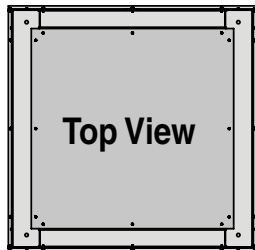
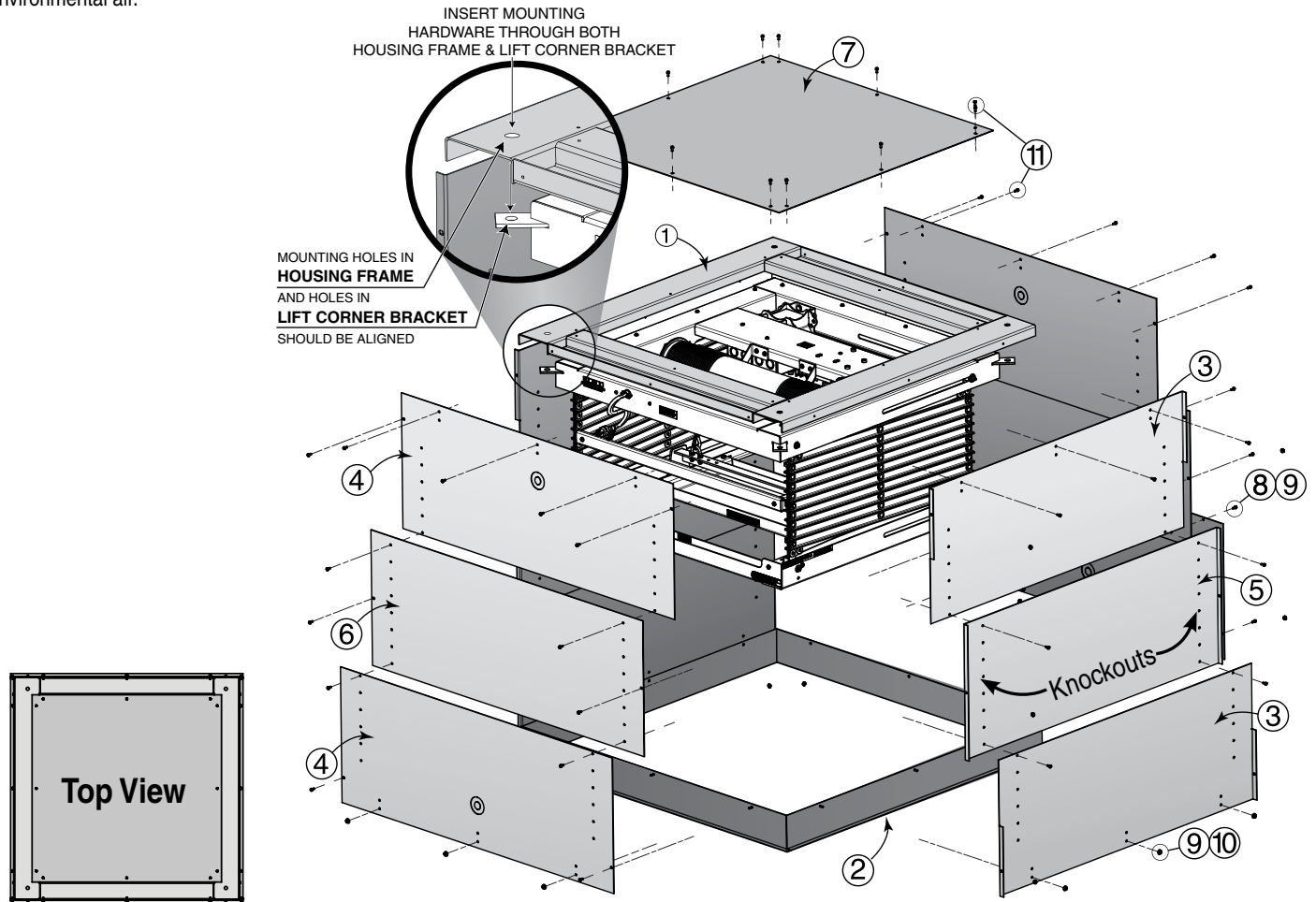

Item	Qty	Part Number	Description
①	1	C028.544.02SA	Frame, SLX Plenum
②	1	C028.545.07SA	Frame, SLX Trim Ring
③	4	C044.178SA	Panel, SLX Plenum Side
④	4	C044.180SA	Panel, SLX Plenum End
⑤	2	C044.179SA	179SA Panel, SLX Middle End
⑥	2	C044.177SA	Panel, SLX Plenum Middle Side
⑦	1	C095.123SA	Cover, SLX Plenum
⑧	28	C020.325	Screw, 8-32 X 3/8" Type 1 HWH
⑨	40	C018.051	Nut #8-32 Zinc Hex Keps
⑩	12	C013.070	Washer, .188" I.D. x .5" O.D. x .07" TK Nylon Flat
⑪	24	C020.112	Screw, 8-32 X 3/8" Type F HWH



Environmental Air Space Housing "SLXR"

Please Note: Before assembling the housing, you will need to determine which assembly holes you will use, and knock them out.

The Environmental Air Space Housing is shipped in pieces, and must be assembled by the installer. The height of the Environmental Air Space Housing is set by drilling out the knockouts at the desired locations then using screws to connect side panels. It is recommended that an access panel be installed in the ceiling to allow future access. The optional environmental air space housing must be installed to isolate the lift from the "other space used for environmental air."

- ① Insert mounting hardware through the top of the Environmental Air Space Housing **and** the top of the Scissor Lift SLXR.
- ② Then, install top panel to Environmental Air Space Housing frame.
- ③ Attach entire assembly to overhead structure using the same mounting hardware from Step 1. Allow clearance between the top of Environmental Air Space Housing and structure for ease of future access.
- ④ Install side and end panels, and trim frame.

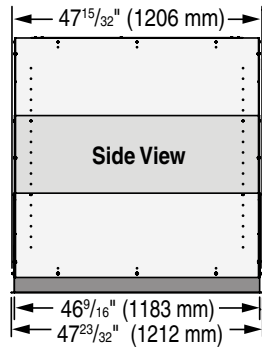
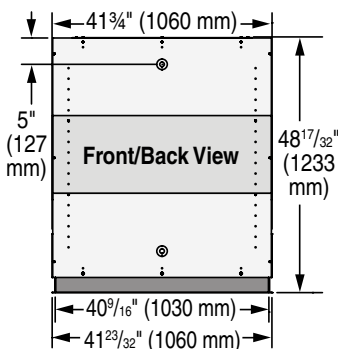
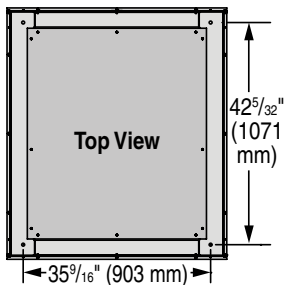
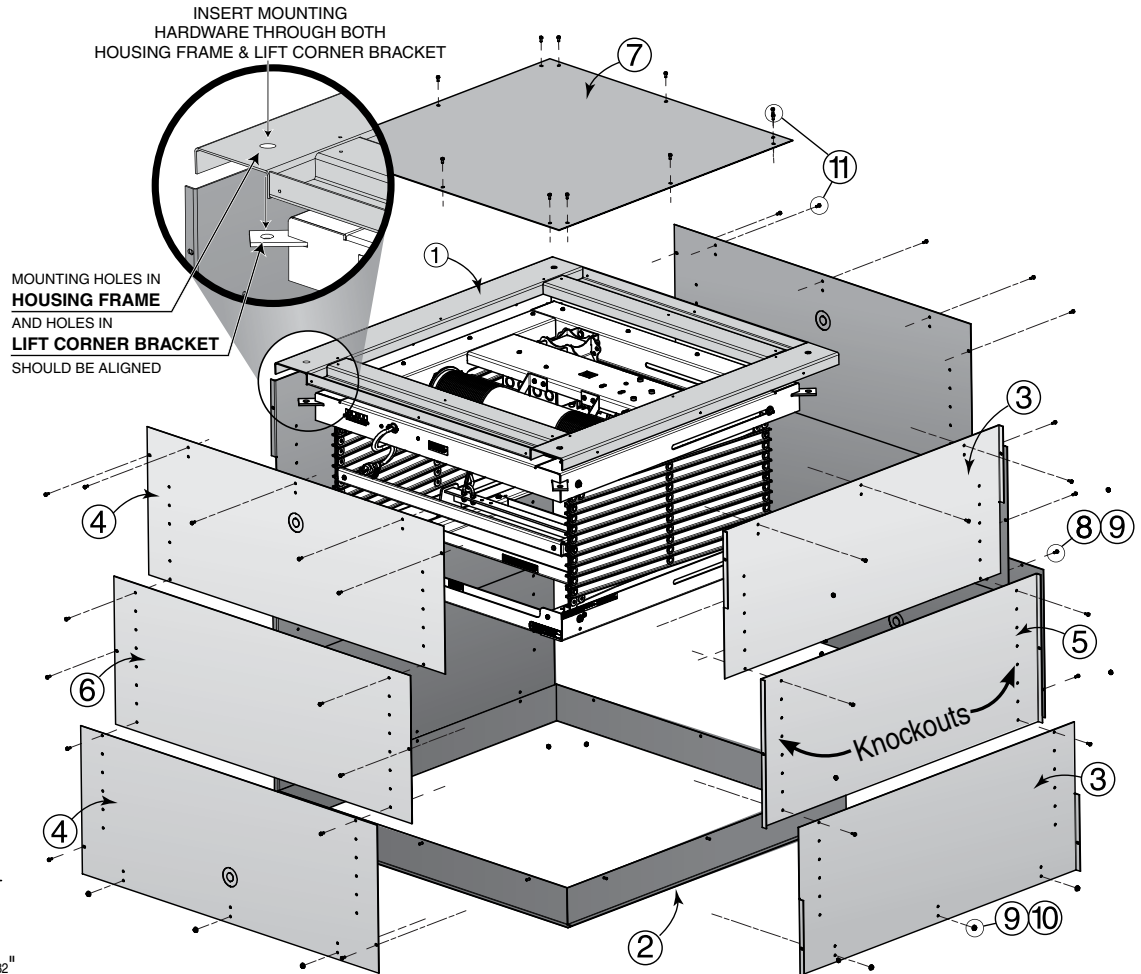

Item	Qty	Part Number	Description
①	1	C028.625.01SA	Frame, SLXR Plenum
②	1	C028.626.07SA	Frame, SLXR Trim Ring
③	4	C044.206SA	Panel, SLXR Plenum Side
④	4	C044.180SA	Panel, SLXR Plenum End
⑤	2	C044.207SA	179SA Panel, SLXR Middle End
⑥	2	C044.177SA	Panel, SLXR Plenum Middle Side
⑦	1	C095.133SA	Cover, SLXR Plenum
⑧	28	C020.325	Screw, 8-32 X 3/8" Type 1 HWH
⑨	40	C018.051	Nut #8-32 Zinc Hex Keps
⑩	12	C013.070	Washer, .188" I.D. x .5" O.D. x .07" TK Nylon Flat
⑪	24	C020.112	Screw, 8-32 X 3/8" Type F HWH